



# WDT-5.0

## BLUETOOTH TRANSCIVER

### User Manual

## Contents

1. Welcome	2
2. Product Overview	3
3. Basic Operation	4
4. Bluetooth Transmitter Mode (TX)	5
5. Bluetooth Receiver Mode (RX)	8
6. Charging	10
7. LED Indicator	11
8. Specifications	12
9. FAQ	13
10. Safety Instructions	14
11. Disposal	15

## 1. Welcome

The WDT-5.0 is a 2-in-1 Bluetooth transmitter and receiver. With the premium CSR8675 chipset and Bluetooth 5.0 technology, this compact and portable adapter delivers fast and reliable wireless connections. When used as a Bluetooth transmitter it can stream the sound of non-Bluetooth devices like your TV or computer to Bluetooth headphones or speakers. When used as a Bluetooth receiver it can be connected to your home audio system for wireless music playback from your Bluetooth-enabled smartphone, tablet or laptop.

The WDT-5.0 supports the aptX™ HD technology in both modes to bring you high-definition wireless audio streaming. The aptX™ Low Latency technology reduces latency to 40 ms so you can enjoy high-quality audio in sync with the picture. To enjoy the advantages of aptX™ your Bluetooth headphones or speaker must support this technology as well.

The adapter can pair and connect to 2 Bluetooth devices simultaneously and store 8 devices for automatic re-pairing with existing paired devices. Equipped with a long-lasting lithium-ion battery, it can continuously play for more than 20 hours, and just needs 2 hours to fully charge. It also supports charging and streaming at the same time. You can use the included wall adapter for charging or any 5V USB port.

The WDT-5.0 supports both analog (3.5mm AUX/RCA) and digital optical (Toslink) audio input and output for universal compatibility. All necessary audio connection cables are included.

## 2. Product Overview

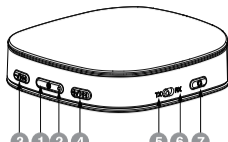

- 1 MFB button
- 2 LED indicator
- 3 Volume/song -
- 4 Volume/song +
- 5 Transmitter mode TX
- 6 Receiver mode RX
- 7 Pairing button

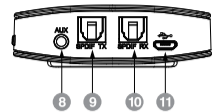

- 8 AUX jack
- 9 SPDIF input
- 10 SPDIF output
- 11 Charging port

### Package Contents

- 1\* WDT-5.0 Bluetooth transceiver
- 1\* Micro USB charging cable
- 1\* Power adapter
- 1\* 3.5 mm audio cable
- 1\* 3.5 mm/RCA adapter cable
- 1\* Digital, optical Toslink cable

## 3. Basic Operation

Element	Function	Operation
Multi-function button (MFB)	Power on/off	Press and hold for 2 seconds to switch on or off.
	Play/Pause	Shortly press to pause and continue replay (RX mode only).
Pairing button	Pairing mode	Shortly press to enter pairing mode. RX mode: LED flashes blue and red. TX mode: LED flashes blue.
Volume +	Volume up	Shortly press when playing music to increase the volume.
	Next song	Press and hold when playing music to jump to the next song.
Volume -	Volume down	Shortly press when playing music to decrease the volume.
	Previous song	Press and hold when playing music to jump to the previous song.

Element	Operation
TX/RX mode switch	Slide to TX to select transmitter mode or slide to RX to select receiver mode.
	Turn off the adapter for 3 seconds before changing the mode.
	When changing the mode, the pairing history will be cleared.
Audio output	Connect the 3.5 mm audio cable to the AUX jack or the Toslink cable to the SPDIF input or output.

## 4. Bluetooth Transmitter Mode (TX)

### 4.1 Bluetooth Pairing and Connection

1. Set the device to TX mode before turning it on. Then press and hold the MFB button for 2 seconds to turn on the device.
2. Tap the pairing button to enter pairing mode. The LED indicator starts flashing blue.
3. Now activate the Bluetooth function on your audio device you wish to pair (e.g. headphones or speaker) and set it to pairing mode.
4. Place your Bluetooth device close to the WDT-5.0. After about 5 to 30 seconds, pairing will be completed. The LED indicator flashes slower.
5. Connect the WDT-5.0 to your audio output device like your TV through the 3.5 mm audio cable or Toslink cable. Now you should be able to hear e.g. the TV sound on your Bluetooth headset.

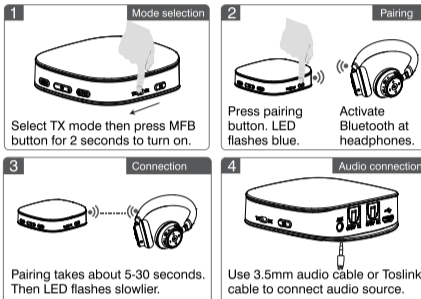

**Note:** Depending on the codec used of the Bluetooth device, the LED indicator will be flashing in different ways (see section 7).

### 4.2 Dual link (simultaneous connection to 2 devices)

The WDT-5.0 can simultaneously stream audio to two Bluetooth headsets. Both can play e.g. the same TV sound.

1. Follow the instructions in section 4.1 to pair the first audio device.
2. Tap the pairing button again and pair the second audio device in the same way. The LED indicator will turn solid green when two audio devices are connected.



## 5. Bluetooth Receiver Mode (RX)

### 5.1 Bluetooth Pairing and Connection

1. Set the device to RX mode before turning it on. Then press and hold the MFB button for 2 seconds to turn on the device.
2. Tap the pairing button to enter pairing mode. The LED indicator starts flashing blue and red.
3. Now activate the Bluetooth function on your audio device or smartphone and start the device scan. Select **OMNI WDT-5.0** from the list and connect the devices. The LED indicator will turn solid blue once the devices are paired.
4. Connect the WDT-5.0 e.g. to your home stereo system through the 3.5 mm audio cable (AUX) or Toslink cable (SPDIF RX) and enjoy wireless playback of music from your smartphone.
5. While music is playing tap the MFB button to pause or resume playback. Tap the Volume +/- buttons to adjust the volume or press and hold them for 2 seconds to skip songs.

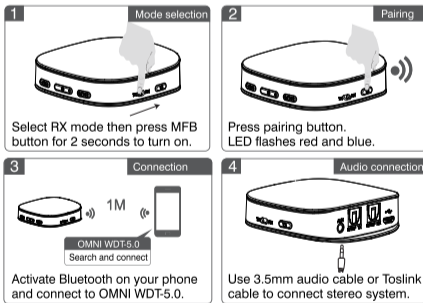

### 5.2 Multipoint connection to 2 devices in receiver mode

The WDT-5.0 can pair with 2 smartphones simultaneously, but can only play music from one device at any time.

1. Follow the instructions in section 5.1 to pair the first device (smartphone, PC, laptop).
2. Tap the pairing button again and pair the second audio device in the same way. The LED indicator will turn solid green when two audio devices are connected.

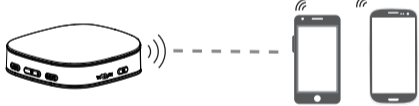

### Notes:

1. You may choose any smartphone to play music, but the other phone needs to pause or end music playback.
2. To enjoy the advantages of aptX™ HD and aptX™ your audio device must support these codecs. In multipoint mode the standard SBC codec will be used automatically.
3. When paired with two devices, the green LED indicator takes priority over the red and blue LED indicators of other modes.

### 5.3 Speaker connection

In receiver mode, you can connect the WDT-5.0 with a non-Bluetooth device like your home stereo or speaker through the 3.5 mm audio cable (AUX) or Toslink cable (SPDIF RX) and transmit audio from your smartphone via Bluetooth.

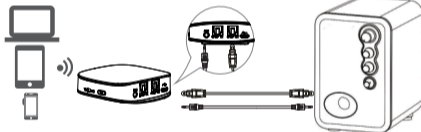

- Notes:**
1. It is advised to switch off the Bluetooth function of your other devices to avoid signal interference.
  2. If you get no sound via Bluetooth, try to connect the speaker and the phone via the 3.5mm audio cable to rule out a malfunction.

## 6. Charging

Please fully charge the WDT-5.0 before first use and when a low battery is indicated. Then the LED indicator starts flashing red. To charge the battery, plug in the USB cable and connect the device to the power adapter and a power outlet or use a USB power source such as a PC or powerbank. While charging the LED indicator will turn solid red. It goes out when fully charged after about 2 hours. You can continue to use the WDT-5.0 while charging.

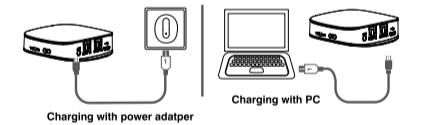

- Notes:**
1. You should charge the battery at least every 2 months even if you do not use the device.
  2. If the battery dies during use, connect the device to a power source and turn it on again with the MFB button.

## 7. LED Indicator

Status	LED Indicator
Power on	LED flashes blue twice
Power off	LED flashes red twice
Pairing mode	LED flashes blue (TX mode)
	LED flashes red and blue (RX mode)
	LED lights solid green (multipoint connection)
Standby (unconnected)	LED flashes blue every second (TX mode)
	LED flashes blue twice every 2 sec (RX mode)
Standby (connected)	LED lights solid blue
aptX™ HD	LED flashes blue 4 times every 10 sec
aptX™ Low Latency	LED flashes blue 3 times every 10 sec
aptX™	LED flashes blue twice every 10 sec
AAC	LED flashes blue once every 10 sec
SBC	LED flashes blue once every 10 sec
Low battery	LED flashes red
Charging	LED lights solid red
Battery fully charged	LED off

## 8. Specifications

Bluetooth	version 5.0		
Chipset	CSR BC8675		
Operation range	class 2, 10 m		
Frequency	2.402-2.480 GHz		
Bluetooth profiles	A2DP, AVRCP		
Supported codecs	RX: aptX™ HD, aptX™ Low Latency, aptX™, AAC, SBC TX: aptX™ HD, aptX™ Low Latency, aptX™, SBC		
Battery type	3.7 V, 350 mA rechargeable lithium battery		
Charging voltage	5 V, 350 mA via micro USB port		
Charging time	2 hours		
Standby time	RX: about 120 hours, TX: up to 20 hours		
Working time	AUX	RX	17.5 hours
		TX	20 hours
	SPDIF	RX	12.5 hours
		TX	14 hours
Weight	36 g		
Dimension	70 x 70 x 22 mm		

Subject to change.

### Notes:

1. Battery operation time will vary depending on ambient conditions and the codec used.
2. The audio codec used depends on the compatibility of the connected device. Single connections will prioritize aptX™ HD, whereas multipoint connections will use the standard SBC codec.

## 9. FAQ

### Q: Does the device power off automatically?

A: In RX mode, the device automatically powers off after 10 minutes without Bluetooth connection with another device. In TX mode, it does not.

### Q: How do I reconnect with previously paired devices?

A: The WDT-5.0 stores the pairing information of 8 devices. After switching on the WDT-5.0 will automatically reconnect to the 2 most recently paired devices if they are within range and switched on. If not, please switch the WDT-5.0 off and on again. If the problem still exists, please try to clear up the stored pairing list and pair your devices again as described in section 4.1 and 5.1.

### Q: How can I clear the pairing history?

A: Please clear the pairing history if pairing failures are encountered. Turn off the device and wait 3 seconds. Then change to the other working mode and power on. All previously paired devices will be cleared from memory.

### Q: Does the Bluetooth connection require a passcode?

A: For some devices you are required to use a passcode for pairing. Please try "0000", "8888", "1111" or "1234".

### Q: What if the device does not power on?

A: Connect to power supply and reboot.

### Q: How do I charge the battery?

A: Connect the device with the power supply using the supplied micro USB cable.

## 10. Safety Instructions

1. Please read these operating instructions carefully before using the product. They contain important information for the correct use of your product. Please keep them for future reference.
2. Only use the product according to the instructions given herein. Damages due to failure to follow these operating instructions will void the warranty! We do not assume any liability for any resulting damage.
3. Unauthorized rebuilds or modifications of the product are not permitted for reasons of safety and render the warranty invalid.
4. This product is not a toy. Keep it out of the reach of children. Do not leave packaging material lying around carelessly.
5. IMPORTANT: This product is not an outdoor product! Only for indoor use! Do not use this device near water.
6. Protect the product against excessive humidity and heat. The recommended temperature is -5 to +45°C.
7. This product is maintenance-free, except for occasional cleaning. You can use a slightly dampened cloth for cleaning. Before cleaning, disconnect the product from the mains.
8. If this product is no longer working properly or is visibly damaged, take it out of operation and consult your local dealer. Do not attempt to repair the product yourself.
9. Never damage the battery. Damaging the casing of the battery might cause an explosion or a fire!
10. Never short-circuit the contacts of the battery. Do not throw the battery or the product into fire. There is a danger of fire and explosion!
11. Charge the battery regularly, even if you are not using the product. If regularly recharged, the battery retains its capacity and is ready to use for several years and thus extremely robust and long-lived. It is normal that a certain amount of heat is generated during charging.

## 11. Disposal

When to be definitively put out of operation, take the product to a local recycling plant for a disposal which is not harmful to the environment. Devices marked with this symbol must not be disposed of as household waste. Contact your retailer or local authorities for more information.

You as the end user are required by law (Battery Ordinance) to return all used batteries/rechargeable batteries. Disposing of them in the household waste is prohibited. You may return your used batteries free of charge to collection points in your municipality and anywhere where batteries/rechargeable batteries are sold. By disposing of used devices and batteries correctly, you contribute to the protection of the environment.



No. 13072198

© 2018 Omnitronic. All rights reserved

Omnitronic is a brand of Steingke Showtechnic GmbH  
Andreas-Bauer-Str. 5 • 97297 Waldbüttelbrunn, Germany