

1 Installieren Sie die Antennen

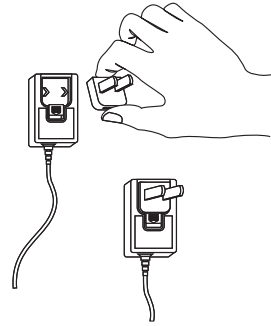

2 Stecken Sie den Adapter auf das Netzteil

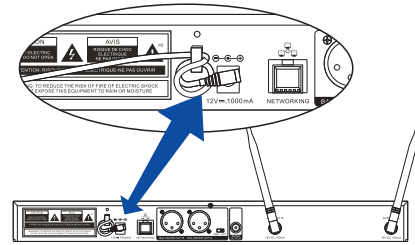

3 Stellen Sie die Stromversorgung her

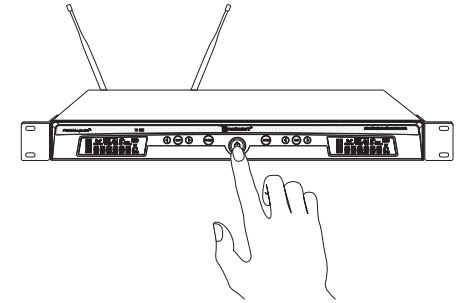

4 Schalten Sie den Empfänger ein

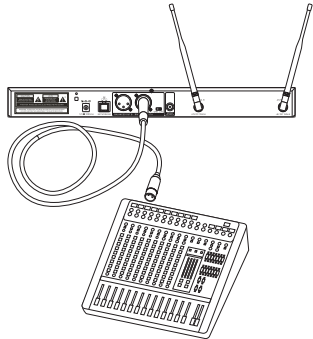

5 Schließen Sie ein Audiogerät an

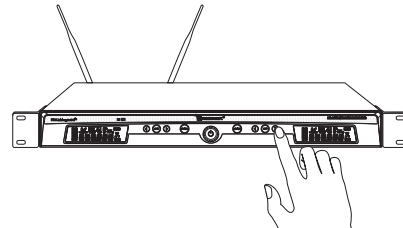

6 Halten Sie ► gedrückt bis AFS erscheint

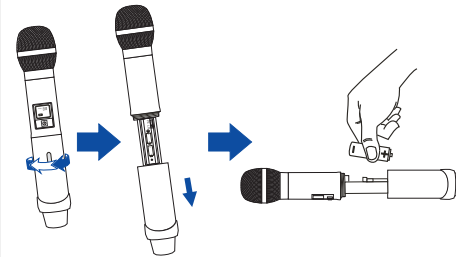

7 Setzen Sie Batterien ein

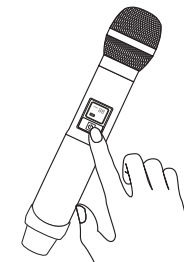

8 Schalten Sie das Mikrofon ein

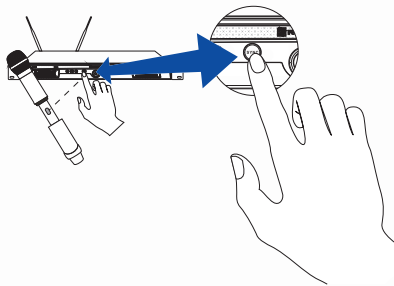

9 Synchronisieren Sie die Geräte

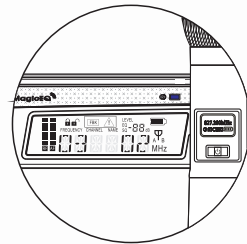

10 Überprüfen Sie den Empfang



11 Sie können Ihr UR-260D verwenden

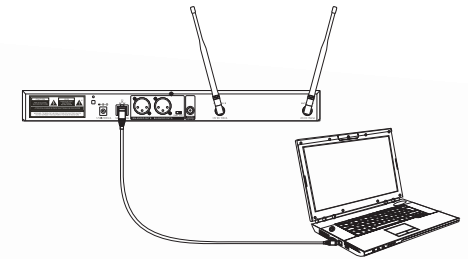

12 Zur Fernsteuerung mit Computer verbinden

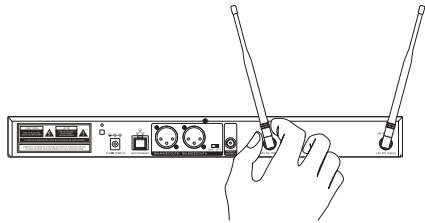

1 Install the antennas

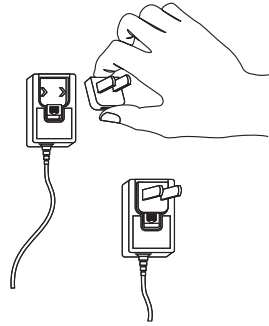

2 Install the AC adapter blades

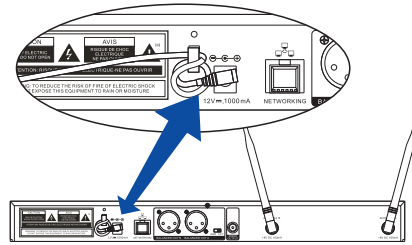

3 Plug receiver into AC power supply

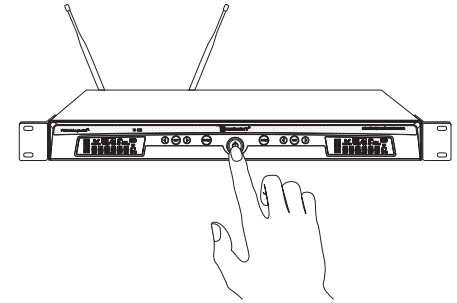

4 Turn on receiver

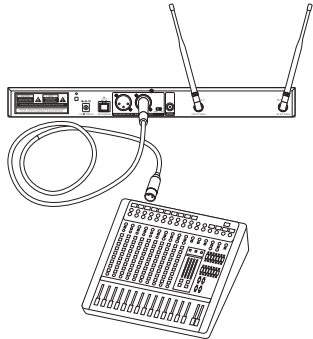

5 Connect receiver to audio system

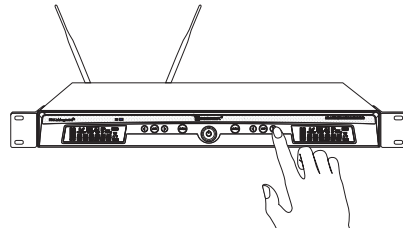

6 Press and hold ► until AFS is indicated

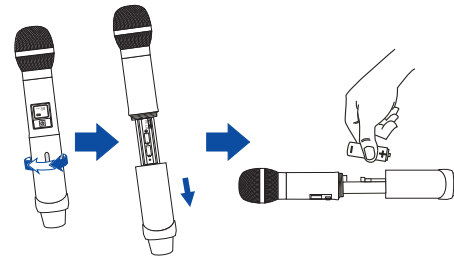

7 Insert batteries into transmitter

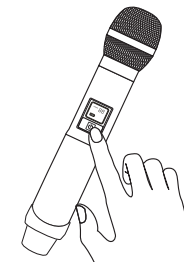

8 Turn on transmitter

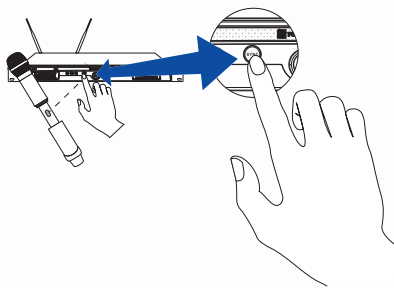

9 Sync receiver and transmitter

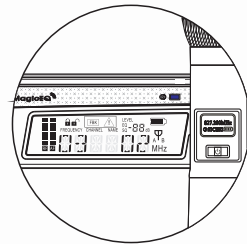

10 Verify reception



11 Start using your UR-260D

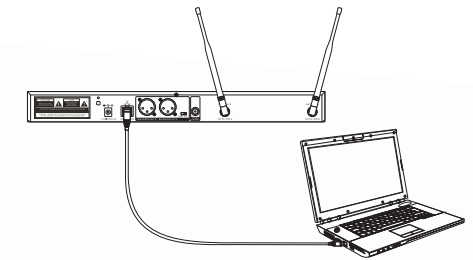

12 Connect to computer for remote control